



# Results. Quick, accurate & reliable

It's as easy as 1, 2, 3 ...

1. easy-to-use swabs



2. a lightweight, ergonomic device



3. complete software to help with your HACCP system in various languages



## Easy-to-use swabs

### Surface control

The 3M™ Clean-Trace™ Surface ATP swab makes it possible to obtain fully quantitative results to determine the cleanliness of a surface within a few seconds.

- Measure total ATP level
- Metal detectable device
- Long swab
- Swab - click - read simplicity

### Process water control

The unique swab design of 3M™ Clean-Trace™ Total Water ATP enables high-precision sampling.

- Measure total ATP level
- Metal detectable device
- Spiral swab design dedicated for water samples
- Swab - click - read simplicity

The 3M™ Clean-Trace™ Surface Positive Control or 3M™ Clean-Trace™ Water Positive Control tests are available to validate correct storage and use of your device.

Swab

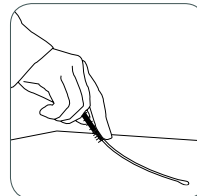

Click

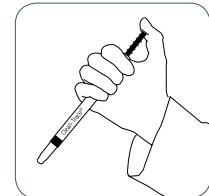

Read

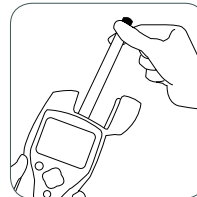

Download



Dip

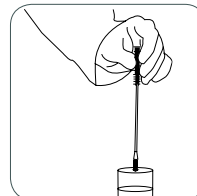

Shake



Read

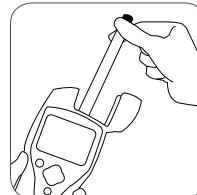

Download

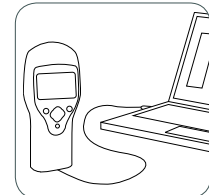



## 3M™ Clean-Trace™ NG Luminometer, a lightweight, ergonomic device

- Photo multiplier enables reliable and reproducible measurements
- Ergonomic, portable design for easy on-site use
- Docking station and USB connection enable fast data transfer to PC
- Rechargeable battery

### Key features

- Weight: 400 g
- Battery operation: 10 hours
- Recording capacity: 10,000 results
- Number of sampling plans in the device: max. 100
- Number of sampling points per plan: max. 300
- Number of sampling points in the device: max. 2,000
- Instrument screen in French, English, Italian, German, Spanish, Danish, Swedish, Japanese
- Recording of re-testing results possible
- Lithium ion battery



## Complete software for your HACCP control plan

Having been specifically developed for HACCP requirements, 3M™ Clean-Trace™ Data Trending software makes it possible to program sample plans into the luminometer. The results are displayed on a decimal scale as RLU\* and in addition a pass/caution/fail interpretation can appear on the screen, to enable easy reading.

Easy to use and available in various languages\*\*, the software will be your new assistant for rapid hygiene controlling and tracking.

\* RLU = relative light unit

\*\* UK, F, I, E, GE

